

1. IDENTIFICATION: VERTICAL, MIXED (24) C-13 & (6) C-19
NETWORKED & ENVIRONMENTAL MONITORED (EXPANDED)
120V / 20A / SINGLE-PHASE POU



PANDUIT P/N	WEIGHT
QM0A1D0BA30P1	17 lb (7.7 kg)

2. ACCESSORY COMPONENTS:
- (4) #10-32 x 1/2" MOUNTING SCREWS
 - (4) #12-24 x 1/2" MOUNTING SCREWS
 - (2) #10-32 LOCKING COLLAR SCREWS
 - (2) L-BRACKETS
 - (1) I/O INSERTION TOOL

3. DIMENSIONS IN PARENTHESES ARE METRIC (mm).

4. AGGREGATE POWER (A,V,PF,KWH) MONITORING CAN BE ACCESSED REMOTELY VIA ETHERNET CONNECTION OR VIA OPTIONAL REMOTE DISPLAY (PVQ-RD). IN ADDITION, ENVIRONMENTAL SENSOR DATA CAN ALSO BE ACCESSED REMOTELY VIA ETHERNET CONNECTION. (EXPANDED) UNITS HAVE 5 ON-BOARD SENSORS THAT MEASURE TEMPERATURE, RELATIVE HUMIDITY, AIR FLOW, LIGHT, AND SOUND.

5. UL® & c-UL® LISTED 60950.

6. RoHS COMPLIANT.

7. VISIT OUR ON-LINE CATALOG AT WWW.PANDUIT.COM FOR A CURRENT LIST OF PRODUCTS APPLICABLE FOR USE WITH THIS PART.

8. MAXIMUM AVAILABLE POWER = 1.9 KW

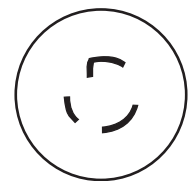
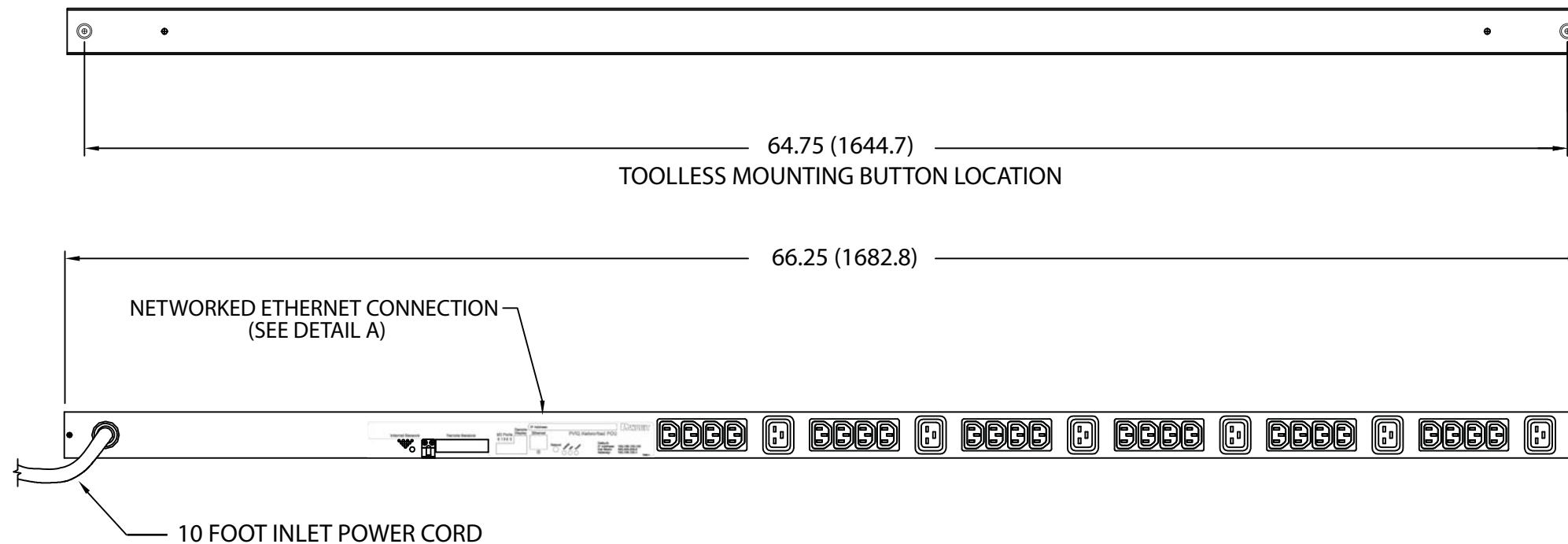
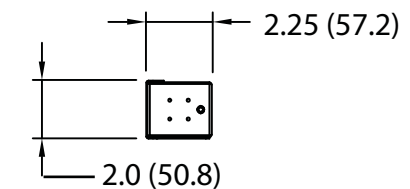

PLUG
20 AMP, 125V, SINGLE-PHASE
TWIST LOCK
NEMA L5-20P

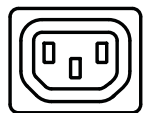

TWENTY-FOUR (24)
RECEPTACLES
15 AMP, 250V
STRAIGHT BLADE
IEC 60320/C13

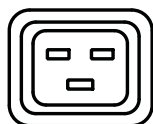

SIX (6)
RECEPTACLES
20 AMP, 250V
STRAIGHT BLADE
IEC 60320/C19

00A	2-7-11	MAV	KRKE	RELEASED TO PRODUCTION	09V098TD				
REV	DATE	BY	CHK	DESCRIPTION	ECN - R	CUST	SUP	OTH	

MODEL FILENAME		09V098TD/00.PRT	
CAD FILENAME/LAYERS		09V098TD_DC/00A.PRT	
PANDUIT CORP TINLEY PARK, ILLINOIS			
VERTICAL, MIXED (24) C-13 & (6) C-19 NETWORKED & ENVIRONMENTAL MONITORED (EXPANDED) POWER OUTLET UNIT (QM0A1D0BA30P1) CUSTOMER DRAWING			
UNLESS OTHERWISE SPECIFIED, DIMENSIONAL TOLERANCES ARE:		UNLESS OTHERWISE SPECIFIED,	
INCHES X.X +/- 0.03 X.XX +/- 0.015 X.XXX +/- 0.005		[METRIC - MILLIMETER] X. +/- 0.8 X.X +/- 0.4 X.XX +/- 0.13	
ANGLE +/- 1°		ALL DIMENSIONS ARE GIVEN IN INCHES, THIRD ANGLE PROJECTION	
DRAWN BY MAV		SCALE NONE	
DATE 2-7-11		DRAWING NO. 09V098TD	
CHK'D KRKE		DWG B	