



15~24W AC-DC Single Output Wall Mount Adaptor

L24D-B series



■ Features :

- 2 pole USA plug
- Class II power(without earth pin)
- Universal AC input / Full range
- Protections: Short circuit/ Over load/ Over voltage
- Topology:PWM 3842 circuit
- 100% full load burn-in test
- Fully enclosed plastic case
- Approvals: UL/ CSA/ PSE/ FCC/ CE
- 1 year warranty



SPECIFICATION

ORDER NO.		L24D05B-P1J	L24D06B-P1J	L24D09B-P1J	L24D12B-P1J	L24D24B-P1J
OUTPUT	SAFETY MODEL NO.	LAD1512D53	LAD1512D63	LAD1512D92	LAD1512DB2	LAD1512DE1
	DC VOLTAGE	5V	6V	9V	12V	24V
	RATED CURRENT	3.0A	3.0A	2.2A	2.0A	1.0A
	CURRENT RANGE	0.2 ~ 3.0A	0.1 ~ 3.0A	0.1 ~ 2.2A	0.1 ~ 2.0A	0.05 ~ 1.0A
	RATED POWER	15W	18W	19.2W	24W	24W
	RIPPLE & NOISE (max.) Note.2	80mVp-p	80mVp-p	90mVp-p	120mVp-p	150mVp-p
	VOLTAGE ADJ. RANGE	Fixed				
	VOLTAGE TOLERANCE Note.3	±5.0%	±5.0%	±3.0%	±3.0%	±3.0%
	LINE REGULATION Note.4	±0.5%	±0.5%	±0.5%	±0.5%	±0.5%
INPUT	LOAD REGULATION Note.5	±4.5%	±4.5%	±2.5%	±2.5%	±2.5%
	SETUP, RISE, HOLD TIME	500ms, 50ms, 8ms at full load				
	VOLTAGE RANGE	90 ~ 264VAC 135~370VDC				
	FREQUENCY RANGE	47~63Hz				
	EFFICIENCY (Typ.)	70%	72%	74%	76%	80%
	AC CURRENT	0.5A / 115VAC				
PROTECTION	INRUSH CURRENT (max.)	25A / 115VAC				
	LEAKAGE CURRENT (max.)	0.25mA / 240VAC				
	OVER LOAD	110~200% rated output power Protection type : Hiccup mode, recovers automatically after fault condition is removed				
ENVIRONMENT	OVER VOLTAGE	110~140% rated output voltage Protection type : Clamp by zener diode				
	WORKING TEMP.	0~+60℃ (Refer to output load derating curve)				
SAFETY & EMC (Note 6)	WORKING HUMIDITY	20%~90% RH non-condensing				
	STORAGE TEMP., HUMIDITY	-20~+85℃, 10~95% RH				
	TEMP. COEFFICIENT	±0.03% / °C (0~50℃)				
	VIBRATION	10~500Hz, 2G 10min./1cycle, period for 60min. each along X, Y, Z axes				
OTHERS	SAFETY STANDARDS	UL1950, CSA22.2 Approved				
	WITHSTAND VOLTAGE	I/P-O/P: 3KVAC				
	ISOLATION RESISTANCE	I/P-O/P: 100M Ohms min./ 500VDC				
	EMI CONDUCTION & RADIATION	Compliance to EN55022(CISPR22) class B				
	HARMONIC CURRENT	Compliance to EN61000-3-2,3				
	EMS IMMUNITY	Compliance to EN61000-4-2,3,4,5,6,11, ENV50204, Light industry level, criteria A				
CONNECTOR	MTBF	700K hrs min. MIL-HDBK-217F(25℃)				
	DIMENSION	80*55*32mm (L*W*H)				
	PACKING	220g ; 70pcs/ 17kg / CARTON				
NOTE	PLUG	Standard type P1J: 2.1φ * 5.5φ * 11mm, turning fork type, center positive for stock ; Other type available by customer requested				
	CABLE	Standard type 18Awg*2c SPT-1 6ft with ferrite core for stock ; Other type available by customer requested				
NOTE		1.All parameters are specified at 115VAC input, rated load, 25℃ 70% RH. Ambient. 2.Ripple & noise are measured at 20MHz by using a 12" twisted pair terminated with a 0.1uf & 47uf capacitor. 3.Tolerance: includes set up tolerance, line regulation, load regulation. 4.Line regulation is measured from low line to high line at rated load. 5.Load regulation is measured from 10% to 100% rated load. 6.The power supply is considered a component which will be installed into a final equipment. The final equipment must be re-confirmed that it still meets EMC directives.				

■ Mechanical Specification

Unit:mm(+/-2mm)

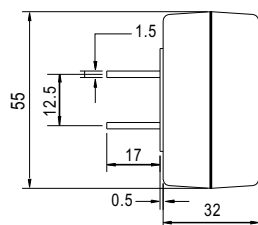
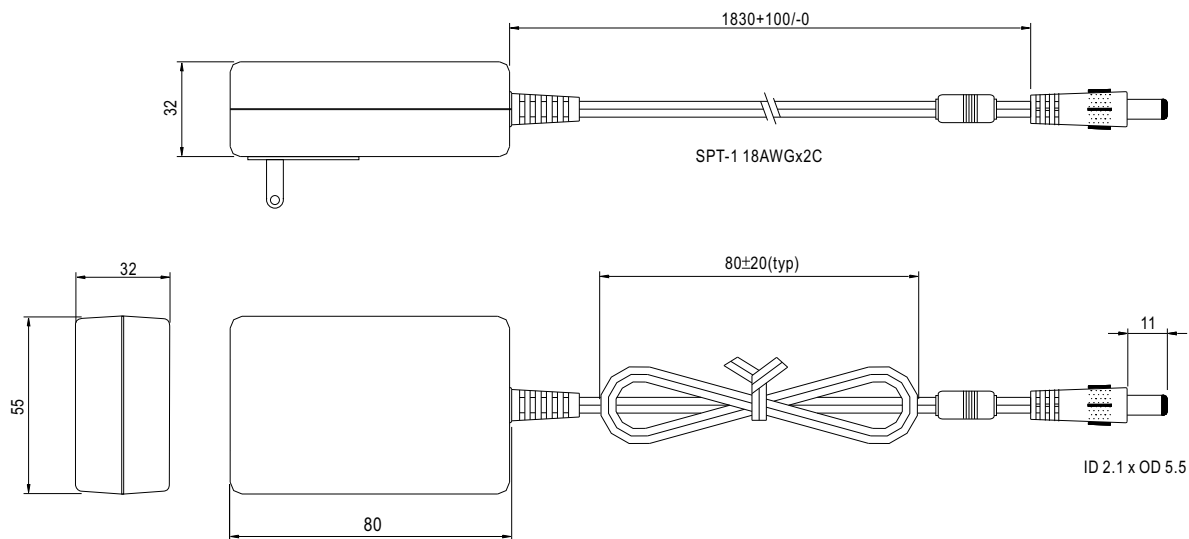

■ Plug Assignment

Standard plug: P1J (option)

P1J	
P/N	OUTPUT
CENTER	+

■ Derating Curve

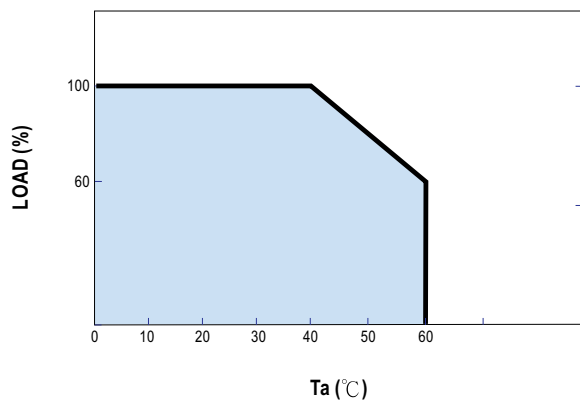

■ Static Characteristics

