

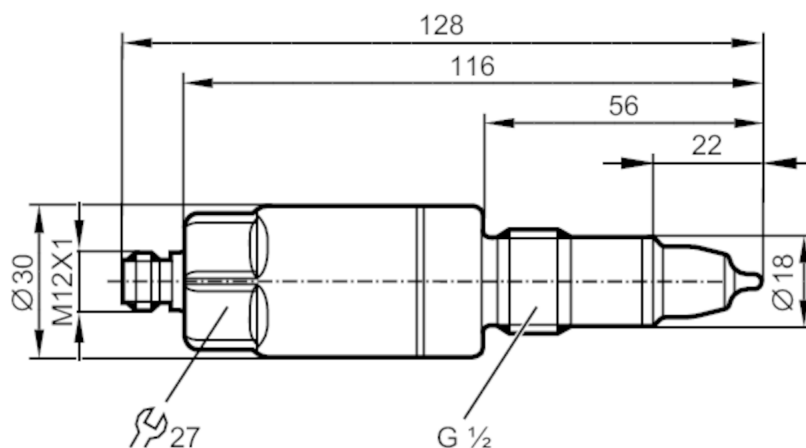

Conductive conductivity sensor

COND CONDUCTIVITY HYG G1/2

Digital meets analogue: integrating modern IO-Link sensors the analogue way. The EIO104 allows you to realise two analogue signals from intelligent IO-Link sensors with several process values.



EC 1935/2004

EHEDG Certified

FCM



IO-Link



Product characteristics

Number of inputs and outputs	Number of analogue outputs: 1
Process connection	threaded connection G 1/2 external thread sealing cone

Application

Special feature	Gold-plated contacts
Media	conductive liquids
Note on media	water
	milk
	CIP liquids
Cannot be used for	See the operating instructions, chapter "Function and features".
Medium temperature [°C]	-25...100; (< 1 h: 150)
Pressure rating [bar]	16
Vacuum resistance [mbar]	-1000

Electrical data

Operating voltage [V]	18...30 DC
Current consumption [mA]	< 60
Protection class	III
Reverse polarity protection	yes
Power-on delay time [s]	2
Measuring principle	konduktiv

Inputs / outputs

Number of inputs and outputs	Number of analogue outputs: 1
------------------------------	-------------------------------

Outputs

Total number of outputs	1
Output signal	analogue signal; IO-Link



Conductive conductivity sensor

COND CONDUCTIVITY HYG G1/2

Output function	analogue output; scalable; selectable conductivity / temperature	
Number of analogue outputs	1	
Analogue current output [mA]	4...20	
Max. load [Ω]	500	
Measuring/setting range		
Conductivity measurement		
Measuring range [μS/cm]	100...15000	
Resolution [μS/cm]	1	
Temperature measurement		
Measuring range [°C]	-25...150	
Accuracy / deviations		
Conductivity measurement		
Accuracy (in the measuring range)	10 % MW ± 25 μS/cm	
Drift [%/K]	0,2 %/K MW ± 25 μS/cm	
Repeatability	5 % MW ± 25 μS/cm	
Long-term stability	1 % MW ± 25 μS/cm	
Temperature measurement		
Accuracy [K]	20...50 °C: < ± 0,5 K; -25...150 °C: < ± 1,5 K	
Repeatability [K]	0,2	
Resolution [K]	0.1	
Response times		
Conductivity measurement		
Response time [s]	< 2; (T09; Damping = 0)	
Temperature measurement		
Response time [s]	< 9; (T09)	
Interfaces		
Communication interface	IO-Link	
Transmission type	COM2 (38,4 kBaud)	
IO-Link revision	1.1	
SDCI standard	IEC 61131-9	
Profiles	Measuring Sensor, Identification and Diagnosis	
SIO mode	no	
Required master port type	A	
Process data analogue	1	
Min. process cycle time [ms]	5.6	
Supported DeviceIDs	Type of operation	DeviceID
	default	921
Operating conditions		
Ambient temperature [°C]	-40...60	
Storage temperature [°C]	-40...85	
Protection	IP 68; IP 69K; (7 days / 3 m water depth / 0.3 bar: IP 68)	

LDL100



Conductive conductivity sensor

COND CONDUCTIVITY HYG G1/2

Tests / approvals		
EMC	DIN EN 61000-6-2	
	DIN EN 61000-6-3	
Shock resistance	DIN EN 60068-2-27	50 g (11 ms)
Vibration resistance	DIN EN 60068-2-6	20 g (10...2000 Hz)
MTTF	[years]	172

Mechanical data		
Weight	[g]	270.5
Materials	stainless steel (316L/1.4404); PEEK; PEI; FKM	
Materials (wetted parts)	PEEK; stainless steel (316L/1.4404)	
Process connection	threaded connection G 1/2 external thread sealing cone	

Remarks		
Remarks	MW = measured value	
Notes	Digital meets analogue: integrating modern IO-Link sensors the analogue way. The EIO104 allows you to realise two analogue signals from intelligent IO-Link sensors with several process values.	
Pack quantity	1 pcs.	

Electrical connection

Connector: 1 x M12 (EN 61067-2-101); coding: A; Contacts: gold-plated



Connection

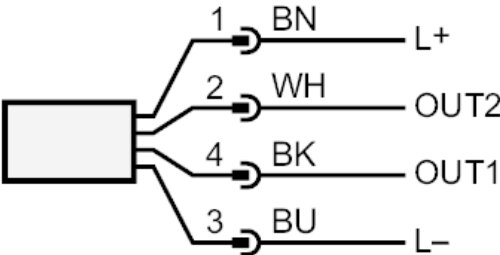

OUT1	IO-Link
OUT2	analogue output
	colours to DIN EN 60947-5-2
	Core colours :
BK =	black
BN =	brown
BU =	blue
WH =	white