

E20966

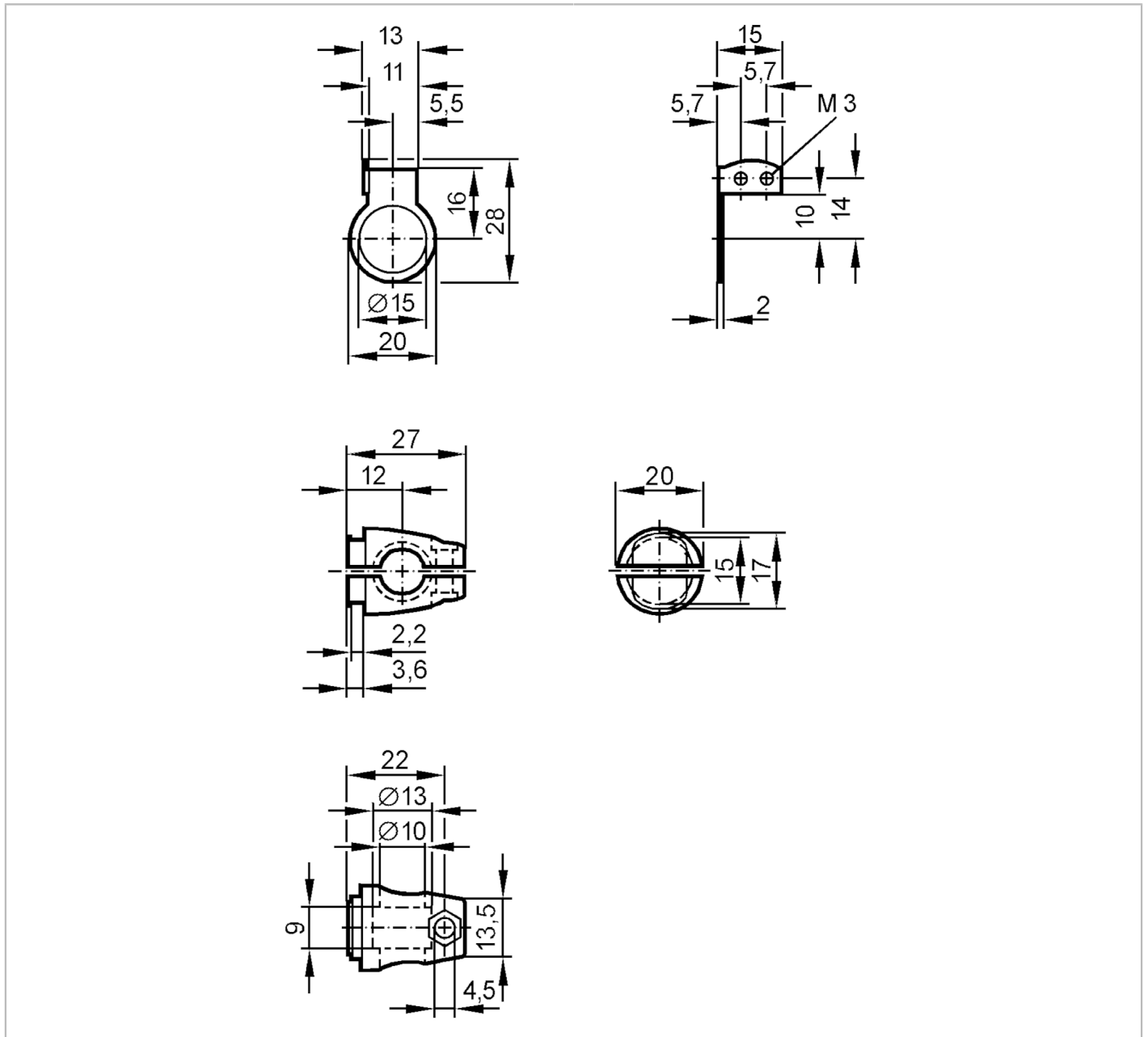

Mounting set for photoelectric sensors

SYSTEM COMPONENT OJ BOLT



Application	
Design	clamp mounting, for front lens
Mechanical data	
Weight [g]	76
Type of mounting	free-standing; (M8)
Materials	Clamp: diecast zinc; fixture: stainless steel (316Ti/1.4571)
Accessories	
Items supplied	screw: 1 x M8 x 40
Remarks	
Pack quantity	1 pcs.