



MATERIAL

Zinc-plated or lacquered steel housing.

STANDARD EXECUTIONS

(AlNiCo) Aluminium-nickel-cobalt magnet, resistant to temperatures up to 280°C.

- **RME-AN-RT**: red coloured lacquered steel housing, for temperatures up to 180°C.

- **RME-AN-ZB**: zinc-plated steel housing, for temperatures up to 200°C. Retaining magnets technical data (on page 1052).

FEATURES AND APPLICATIONS

RME flat retaining magnets are shielded magnetic systems with high performances and moderate overall dimensions.

To ensure that the adhesive force is not impaired, the fixing screws must be made out of non-magnetic material.



Conversion Table	
1 mm = 0.039 inch	
D	
mm	inch
19	0.74
29	1.13
38	1.48

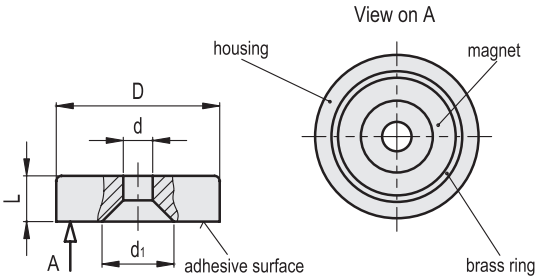

RME-AN-RT

Code	Description	D#	D##	d	L	d1	Nominal adhesive forces* [N]	⚖
501401	RME-AN-RT-19	19	19.1 ±0.5	3.7	7.5 ±0.3	8.7	30	17
501411	RME-AN-RT-29	29	28.6 ±1	4.8	8.5 ±0.5	10.5	50	43
501421	RME-AN-RT-38	38	38.1 ±1	4.8	10.5 ±0.3	10.5	130	107

RME-AN-ZB

Code	Description	D#	D##	d	L	d1	Nominal adhesive forces* [N]	⚖
501406	RME-AN-ZB-19	19	19.1 ±0.5	3.7	7.5 ±0.3	8.7	30	17
501416	RME-AN-ZB-29	29	28.6 ±1	4.8	8.5 ±0.5	10.5	40	43
501426	RME-AN-ZB-38	38	38.1 ±1	4.8	10.5 ±0.3	10.5	80	82

* The values of the nominal adhesive forces are approximate and refer to magnetic properties observed on laboratory samples.

Nominal dimension

Real dimension