

■ Features

- Power Rating: 80W
- Input Voltage: 100-277Vac
- Constant current design
- Fixed output current(300mA-2000mA)
- Efficiency to 88%
- 0-10V/PWM/RX Dimming
- Dimming range 0-100%
- Dim-to-off
- OCP, SCP
- UL Class P / Class 2
- IP20
- 5-year warranty
- Surge Protection level L-N: 1kv

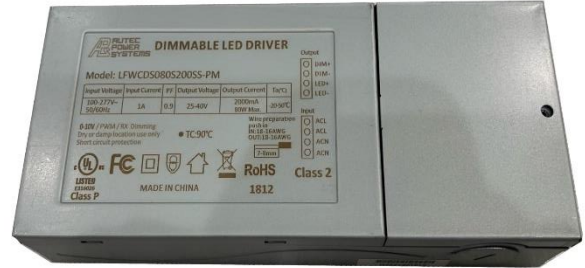

*Product images are for illustrative purposes only and may vary from actual design.

■ Application

- Indoor or outdoor lights
- Dry or Damp locations

■ Model List*(See part number scheme for model number details)

Model Number	Input Voltage Range	Output Power	Output Voltage	Output Current Min.	Output Current Max.	Efficiency	Certification
LFWCD080S030SS-PM	100-277Vac	80W	25-40V	300mA	300mA	88%	UL
LFWCD080S040SS-PM	100-277Vac	80W	25-40V	400mA	400mA	88%	UL
LFWCD080S050SS-PM	100-277Vac	80W	25-40V	500mA	500mA	88%	UL
LFWCD080S060SS-PM	100-277Vac	80W	25-40V	600mA	600mA	88%	UL
LFWCD080S070SS-PM	100-277Vac	80W	25-40V	700mA	700mA	88%	UL
LFWCD080S080SS-PM	100-277Vac	80W	25-40V	800mA	800mA	88%	UL
LFWCD080S090SS-PM	100-277Vac	80W	25-40V	900mA	900mA	88%	UL
LFWCD080S100SS-PM	100-277Vac	80W	25-40V	1000mA	1000mA	88%	UL
LFWCD080S110SS-PM	100-277Vac	80W	25-40V	1100mA	1100mA	88%	UL
LFWCD080S120SS-PM	100-277Vac	80W	25-40V	1200mA	1200mA	88%	UL
LFWCD080S130SS-PM	100-277Vac	80W	25-40V	1300mA	1300mA	88%	UL
LFWCD080S140SS-PM	100-277Vac	80W	25-40V	1400mA	1400mA	88%	UL
LFWCD080S150SS-PM	100-277Vac	80W	25-40V	1500mA	1500mA	88%	UL
LFWCD080S160SS-PM	100-277Vac	80W	25-40V	1600mA	1600mA	88%	UL
LFWCD080S170SS-PM	100-277Vac	80W	25-40V	1700mA	1700mA	88%	UL
LFWCD080S180SS-PM	100-277Vac	80W	25-40V	1800mA	1800mA	88%	UL
LFWCD080S190SS-PM	100-277Vac	80W	25-40V	1900mA	1900mA	88%	UL
LFWCD080S200SS-PM	100-277Vac	80W	25-40V	2000mA	2000mA	88%	UL

■ Technical Data

Input voltage range	100-277Vac
Frequency	47-63Hz
Power factor	> 0.9 under 120~277Vac input with 80~100% load condition (for all output currents)
THD	< 15% under 120~277Vac input with 80~100% load condition (for all output currents)
Current accuracy	±3%
Efficiency	87%@100-277Vac & 100% load (see charts)
Output Voltage	25-40V
Protection	Open circuit protection: Hiccup mode. Protection will trigger when load voltage exceeds specified output voltage and will auto recover after the fault mode is removed. Short circuit protection: Hiccup mode. Protection will trigger when short circuit and will auto recover after the fault mode is removed.
Dimensions LxWxH	180x76x33mm
Weight	TBD
Packing	28pcs/carton; Carton 485x342x201mm

■ Safety Compliance

Safety Standard	GB19510.1, GB19510.14; EN61347-1, EN61347-2-13; UL8750, CSA C22.2 No. 250.13-12
Dielectric Strength	I/P-OP:3750Vac/5mA/60S
Insulation Resistance	I/P-O/P: > 10M Ohms/500Vdc/25°C/70% RH
Leakage Current	The leakage current shall be less than 0.25mA for Class 2 at maximum input voltage
EMI	GB17743, GB17625.1; EN55015, EN61000-3-2, EN61000-3-3
EMS	EN61000-4-2,3,4,5,6,8,11, EN61547

Notes:

- The parameters above including the power factor, THD, efficiency are all tested under the ambient temperature 25°C and humidity 50%, AC input 230V and 90% output load.
- Io is rated output current.

■ Dimming Features

Dimming Function			0-10V			PWM			RX			
			✓			✓			✓			
%	0	10	20	30	40	50	60	70	80	90	100	open
0-10V	0	9.4%	21.65%	33.23%	45.29%	57.64%	69.8%	82.05%	94.01%	100%	100%	100%
PWM	0	10.92%	25.54%	39.31%	52.04%	64%	75.02%	85.37%	94.58%	100%	100%	100%
RX	0	9.4%	21.65%	32.23%	45.29%	57.64%	69.8%	82.05%	94.01%	100%	100%	100%

Notes:

- % refers to the percentage of the dimming signal.
- 0-10V, PWM, RX refers to three different dimming functions, the percentage of the output current for the corresponding dimming signal percentages.

■ Mechanical Diagram

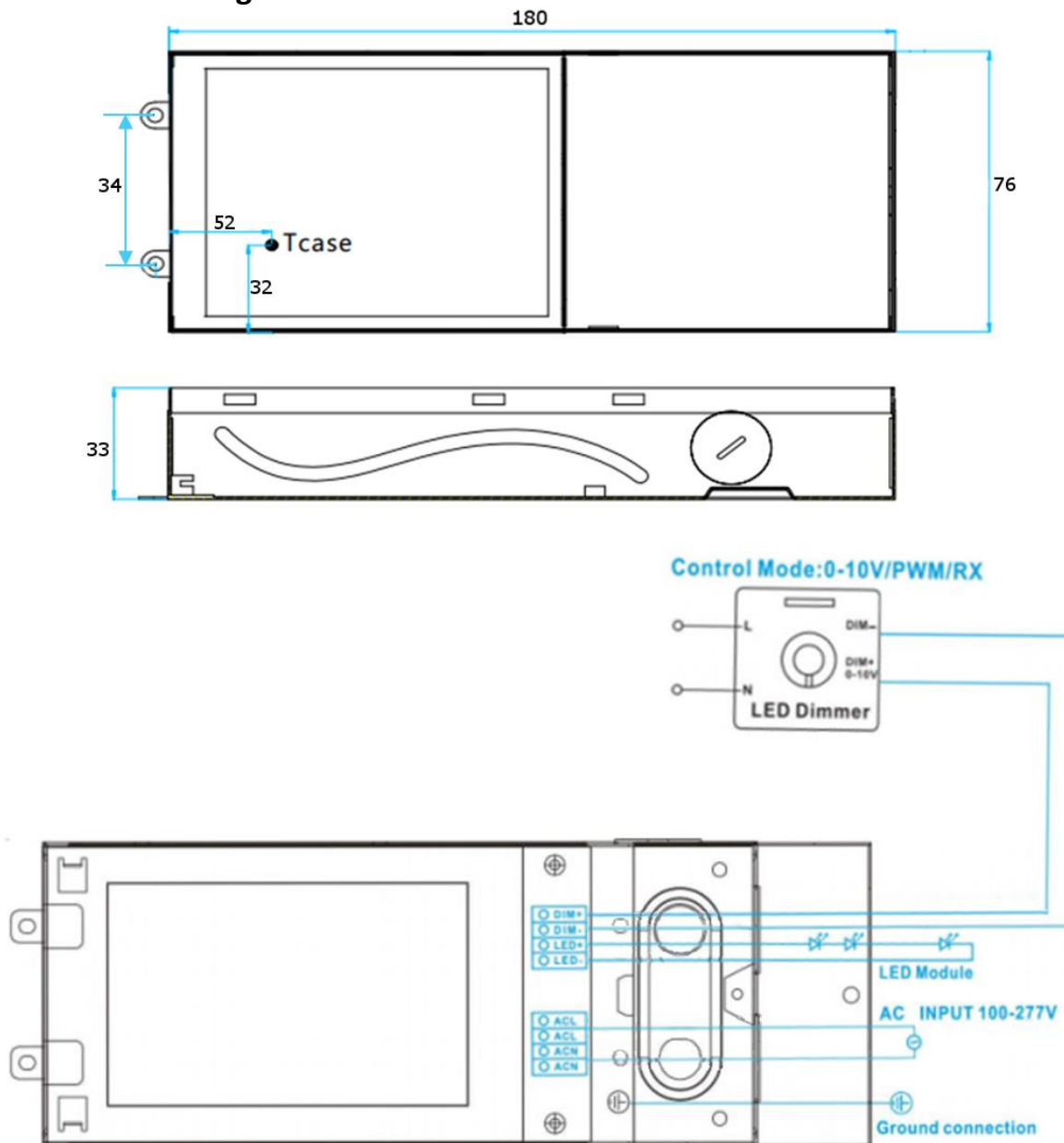

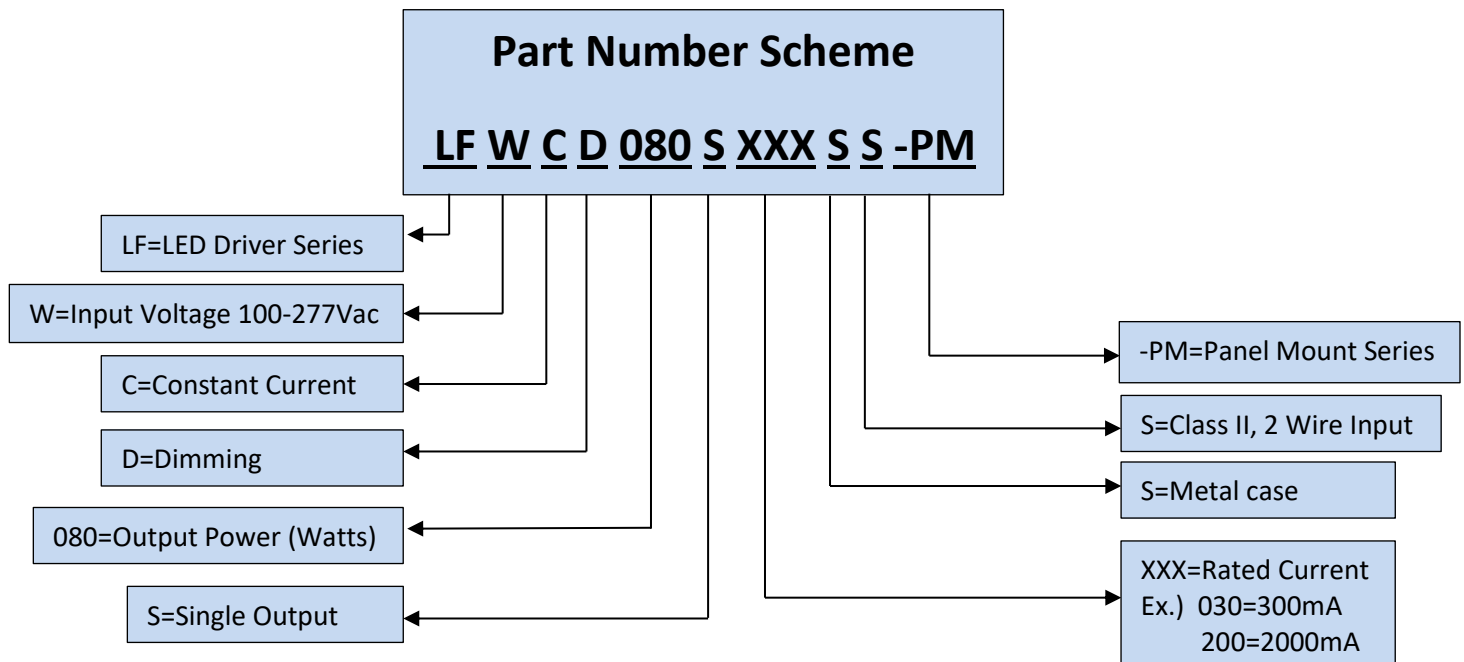

***Product images are for illustrative purposes only and may vary from actual design.**

***Specifications are subject to change without notice. Autec is not responsible for issues arising from errors or omissions.**