

### ■ Features

- Power Rating: 50W
- Input Voltage: 120-277Vac
- Constant current design
- Fixed output current(700mA-1150mA)
- Efficiency to 87%
- 0-10V/PWM Dimming
- Dimming range 5-100%
- Dimming flicker free
- OVP, SCP
- UL Class P, Class II Protection, SELV output
- 5-year warranty
- Surge Protection level L-N: 1kv; L/N-GND: 2kv



\*Product images are for illustrative purposes only and may vary from actual design.

### ■ Application

- Indoor or outdoor lights

### ■ Model List\*(See part number scheme for model number details)

Model Number	Input Voltage Range	Output Power	Output Voltage	Output Current Min.	Output Current Max.	Efficiency	Certification
L7WCD050S070SS-PM05	120~277Vac	50W	27-42V	700mA	700mA	87%	UL
L7WCD050S080SS-PM05	120~277Vac	50W	27-42V	800mA	800mA	87%	UL
L7WCD050S090SS-PM05	120~277Vac	50W	27-42V	900mA	900mA	87%	UL
L7WCD050S100SS-PM05	120~277Vac	50W	27-42V	1000mA	1000mA	87%	UL
L7WCD050S115SS-PM05	120~277Vac	50W	27-42V	1150mA	1150mA	87%	UL

### ■ Technical Data

Input voltage range	120~277Vac
Frequency	50/60Hz
Power factor	> 0.9 under 120~277Vac input with 80~100% load condition (for all output currents)
Inrush current	50A @277Vac
Max input current	0.65A @100Vac
Ripple & noise	<1Vp-p
THD	< 20% under 120~277Vac input with 80~100% load condition (for all output currents)
Turn-on Delay Time	1s Max. at full load condition
Protection	Over voltage protection: Hiccup mode. Protection will trigger when load voltage exceeds specified output voltage and will auto recover after the fault mode is removed. Short circuit protection: Hiccup mode. Protection will trigger when short circuit and will auto recover after the fault mode is removed.

**Technical Sales / Customer Service:** +1-818-338-7788 • Email: [sales@autec.com](mailto:sales@autec.com)

31328 Via Colinas Suite 102 • Westlake Village, CA 91362 USA • [www.autec.com](http://www.autec.com)

July 1, 2019

1 / 4

## ■ Technical Data(cont.)

Operating Temperature	20°C to +50°C
Relative Humidity	20%RH to 90%RH
Storage Temperature	-25°C to +70°C
Relative humidity	10%RH to 90%RH
Burn-in	The Power supply shall under go a minimum of 2-4 hours burn-in test at 45°C ±5°C
MTBF	50,000 hours at 25°C at full load and nominal input condition
Dimensions LxWxH	186.7x83x33.9mm 7.35x3.3x1.33in
Packing	16pcs per carton

## ■ Safety Compliance

Dielectric Strength	Primary to Secondary: 1800Vac 5mA Max/60seconds
	Ground to primary: 1800Vac 5mA Max/60seconds
	Ground to Secondary: 500Vac 5mA Max/60seconds
Insulation Resistance	50Ω min at primary to secondary add 500Vdc test voltage
EMI Standard	FCC, Class B

### Disclaimer:

Autec Power Systems' (Autec) LED Drivers are Hi-Pot tested during the manufacturing process. Autec assumes no responsibility for secondary Hi-Pot testing at customer location or designated production line(s). Should customer require further Hi-Pot testing, at their own production line, following assembly of the LED Driver into the customer's assembled fixture, Autec requests advance notice. This request must be communicated to Autec in a timely manner and is recommended to be requested at time of issuing each purchase order.

## ■ Mechanical Diagram

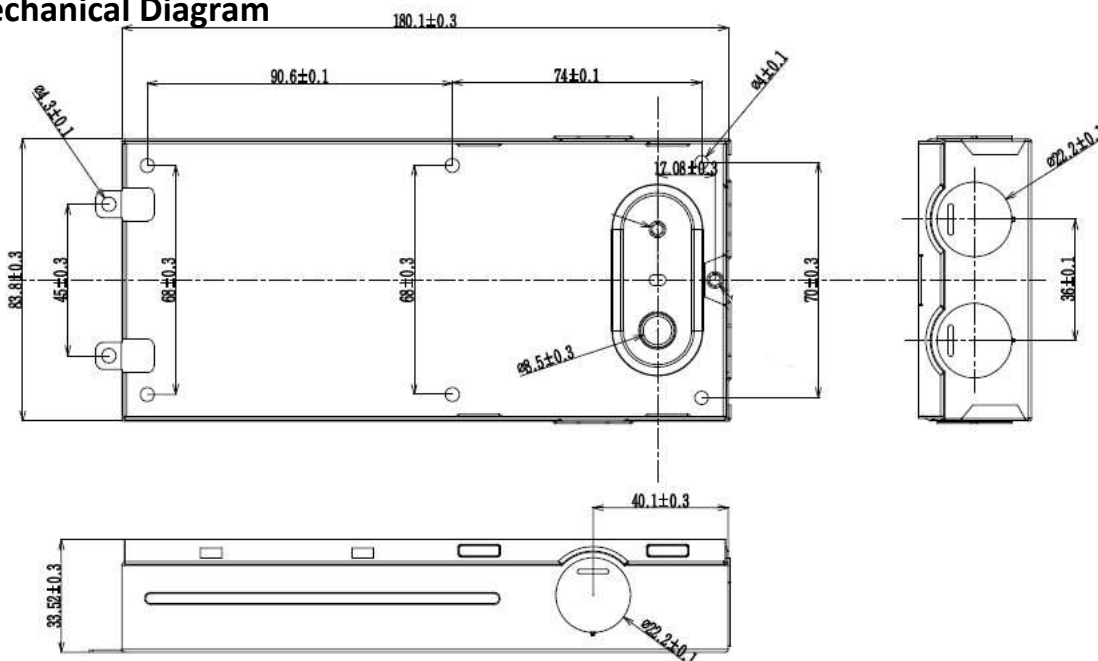

**Technical Sales / Customer Service:** +1-818-338-7788 • Email: [sales@autec.com](mailto:sales@autec.com)  
 31328 Via Colinas Suite 102 • Westlake Village, CA 91362 USA • [www.autec.com](http://www.autec.com)

July 1, 2019

## ■ 0-10V Dimming Curve

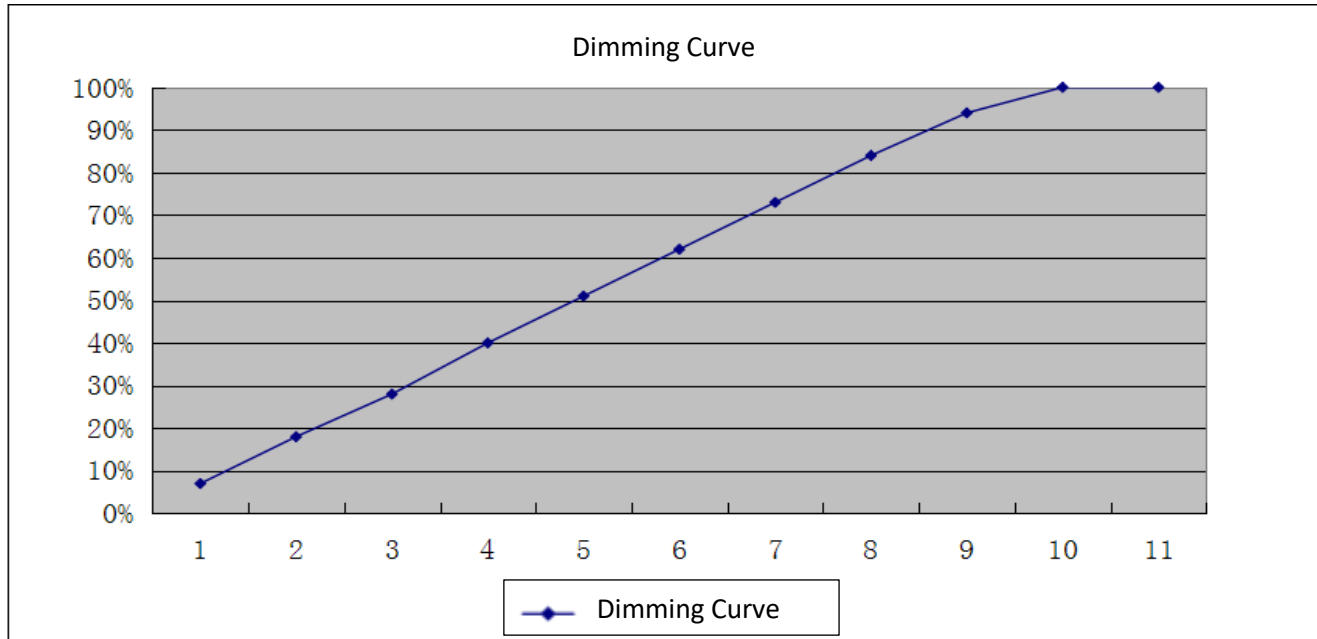

## ■ PWM Dimming

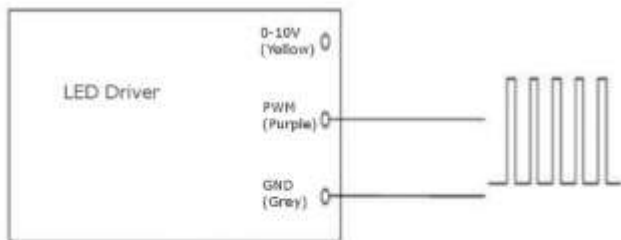

### Part Number Scheme

**L7 W C D 050 S XXX S S -PM 05**

L7=LED Driver Series

W=Input Voltage 120-277Vac

C=Constant Current

D=Dimmable

050=Output Power Watts

S=Single Output

05=5-100% Dimming

-PM=Panel Mount Series

S=Class II, 2 Wire Input

S=Metal case

XXX=Rated Current  
Ex.) 070=700mA  
115=1150mA

**\*Product images are for illustrative purposes only and may vary from actual design.**

**\*Specifications are subject to change without notice. Autec is not responsible for issues arising from errors or omissions.**

**Technical Sales / Customer Service:** +1-818-338-7788 • Email: [sales@autec.com](mailto:sales@autec.com)

31328 Via Colinas Suite 102 • Westlake Village, CA 91362 USA • [www.autec.com](http://www.autec.com)

July 1, 2019

4 / 4