

Accelerometer with armored integral cable

SM103

SPECIFICATIONS

Sensitivity, $\pm 15\%$		100 mV/g
Acceleration range		50 g
Amplitude nonlinearity		1%
Frequency response, ± 3 dB		0.5 - 10,000 Hz
Resonance frequency		25 kHz
Transverse sensitivity, max		7% of axial
Temperature response		see graph
Power requirement:		
Voltage source		18 - 28 VDC
Current regulating diode		2 - 20 mA
Electrical noise, equiv. g:		
Broadband	1 Hz to 10 kHz	350 μ g
Spectral	10 Hz	8 μ g/ $\sqrt{\text{Hz}}$
	100 Hz	5 μ g/ $\sqrt{\text{Hz}}$
	1,000 Hz	4 μ g/ $\sqrt{\text{Hz}}$
Output impedance, max		150 Ω
Bias output voltage		8 to 12 VDC
Grounding		case isolated, internally shielded
Temperature range		-50° to +120°C
Vibration limit		500 g peak
Shock limit		5,000 g peak
Sealing		hermetic
Enclosure rating		IP67
Sensing element design		ceramic, shear
Weight (without cable)		31 grams
Case material		stainless steel
Mounting		1/4-28 stud
Integral cabling¹		side exit, integral cable, polyurethane with stainless steel armor jacket, 10 ft. standard length

Notes: ¹ Other cable lengths may be specified by customer at time of order.
Accessories supplied: mounting base; calibration data (level 2)

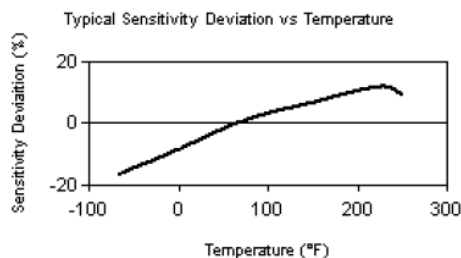

Key features

- Low profile
- Pivoting base
- 10 ft. armored jacketed integral cable

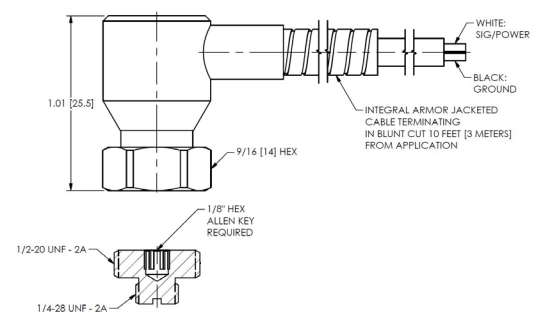
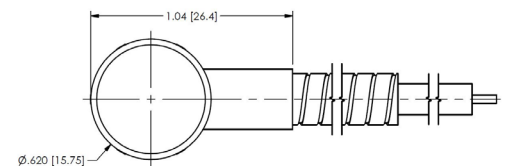

Connections

Function	Cable conductor color
power/signal	white
ground	black

Note: Due to continuous process improvement, specifications are subject to change without notice.