



Abbatron
Premier Supplier of Electronic Hardware

HH Smith

| | | | | | |
|---------------------|------------------|---------------------|------------|----------|-------------------|
| Custom Capabilities | Test Accessories | Plugs, Jacks, Posts | Connectors | Hardware | Spacers/Standoffs |
|---------------------|------------------|---------------------|------------|----------|-------------------|

- [Home](#)
- [About](#)
- [Abbatron](#)
- [Products](#)
- [Locate](#)
- [Distributor](#)
- [or](#)
- [Representative](#)
- [Contact Us](#)
- [Request](#)
- [Information](#)
- [Site Map](#)

Brass Spacers

Brass spacers stand up moderately well to extreme environmental conditions, including heat and humidity. Nickel plating, easily soldered with activated flux, offers further strength against difficult ambient conditions.

- Alternative finishes available
- Other sizes available in quantity upon request
- Call Abbatron's engineering services for special application parts or materials

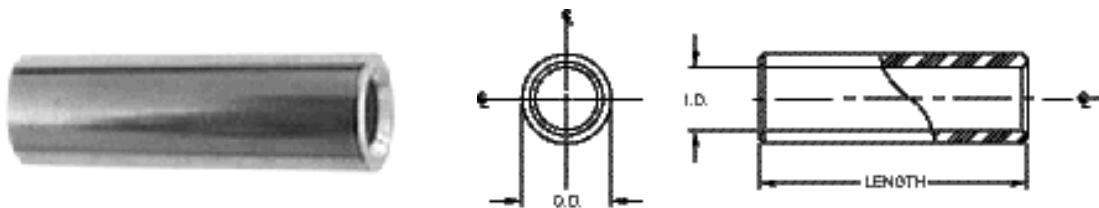

Inventory Search

Cross Reference

UPS Tracking

632 Arch Street, POB
726 Meadville, PA 16335
USA 814-724-6440

[Contact Webmaster](#)

© June 6, 2005

| Length | | O.D. | I.D. | | | | |
|--------|-------|------|------|------|-------|-------|-------|
| | | | #2 | #4 | #6 | #8 | #10 |
| .125 | 1/8 | 3/16 | 9000 | 9015 | | | |
| | | 1/4 | | 8700 | 8701 | 8702 | |
| | | 5/16 | | | 9372A | 9373A | 9374A |
| | | 3/8 | | | | 8732 | 9375A |
| .187 | 3/16 | 3/16 | 9001 | 9016 | | | |
| | | 1/4 | | 8703 | 8704 | 8705 | |
| | | 5/16 | | | 9372B | 9373B | 9374B |
| | | 3/8 | | | | 8735 | 9375B |
| .250 | 1/4 | 3/16 | 9002 | 9017 | | | |
| | | 1/4 | | 2340 | 2100 | 2105 | |
| | | 5/16 | | | 9372C | 9373C | 9374C |
| | | 3/8 | | | | 2115 | 9375C |
| .312 | 5/16 | 3/16 | 9003 | 9018 | | | |
| | | 1/4 | | 8706 | 8707 | 8708 | |
| | | 5/16 | | | 9372D | 9373D | 9374D |
| | | 3/8 | | | | 8738 | 9375D |
| .375 | 3/8 | 3/16 | 9004 | 9019 | | | |
| | | 1/4 | | 2341 | 2101 | 2106 | |
| | | 5/16 | | | 9372E | 9373E | 9374E |
| | | 3/8 | | | | 2116 | 9375E |
| .437 | 7/16 | 3/16 | 9005 | 9020 | | | |
| | | 1/4 | | 8709 | 8710 | 8711 | |
| | | 5/16 | | | 9372F | 9373F | 9374F |
| | | 3/8 | | | | 8741 | 9375F |
| .500 | 1/2 | 3/16 | 9006 | 9021 | | | |
| | | 1/4 | | 2342 | 2102 | 2107 | |
| | | 5/16 | | | 9372G | 9373G | 9374G |
| | | 3/8 | | | | 2117 | 9375G |
| .562 | 9/16 | 3/16 | 9007 | 9022 | | | |
| | | 1/4 | | 8712 | 8713 | 8714 | |
| | | 5/16 | | | 9372H | 9373H | 9374H |
| | | 3/8 | | | | 8744 | 9375H |
| .625 | 5/8 | 3/16 | 9008 | 9023 | | | |
| | | 1/4 | | 8715 | 8716 | 8717 | |
| | | 5/16 | | | 9372J | 9373J | 9374J |
| | | 3/8 | | | | 8747 | 9375J |
| .687 | 11/16 | 3/16 | 9009 | 9024 | | | |
| | | 1/4 | | 8718 | 8719 | 8720 | |
| | | 5/16 | | | 9372K | 9373K | 9374K |
| | | 3/8 | | | | 8750 | 9375K |
| .750 | 3/4 | 3/16 | 9010 | 9025 | | | |
| | | 1/4 | | 2343 | 2103 | 2108 | |
| | | 5/16 | | | 9372L | 9373L | 9374L |
| | | 3/8 | | | | 2118 | 9375L |
| .812 | 13/16 | 3/16 | 9011 | 9026 | | | |
| | | 1/4 | | 8721 | 8722 | 8723 | |
| | | 5/16 | | | 9372M | 9373M | 9374M |
| | | 3/8 | | | | 8753 | 9375M |
| .875 | 7/8 | 3/16 | 9012 | 9027 | | | |
| | | 1/4 | | 8724 | 8725 | 8726 | |
| | | 5/16 | | | 9372N | 9373N | 9374N |
| | | 3/8 | | | | 8756 | 9375N |
| .937 | 15/16 | 3/16 | 9013 | 9028 | | | |
| | | 1/4 | | 8727 | 8728 | 8729 | |
| | | 5/16 | | | 9372P | 9373P | 9374P |
| | | 3/8 | | | | 8759 | 9375P |
| 1.000 | 1 | 3/16 | 9014 | 9029 | | | |
| | | 1/4 | | 2344 | 2104 | 2109 | |
| | | 5/16 | | | 9372Q | 9373Q | 9374Q |
| | | 3/8 | | | | 2119 | 9375Q |

| | | | | | | | |
|-------|---|------|--|--|-------|-------|-------|
| 1.000 | 1 | 5/16 | | | 9372Q | 9373Q | 9374Q |
| | | 3/8 | | | | 2119 | 9375Q |

[home](#) | [about abbatron](#) | [products](#) | [locate distributor or representative](#) | [contact us](#) | [request information](#) | [site map](#)